

A large red square frame with a thick border, centered on the page. The text 'THE FENCE BOOK' is centered within this frame.

# **THE FENCE BOOK**





# THE EVOLUTION OF FENCING...

---

From hand-split Post&Rail, to the stone walls of the Central Otago miners cottage - fencing has been enhancing our properties and protecting the things we love for generations.

A fence is more than a boundary; it is the intersection between the public and private, the work and play, the hustle and bustle of everyday life and the oasis of home.

At Boundaryline, we are proud to encapsulate the Kiwi dream. The four edges of your boundary hold everything that is dear.

We make fencing easy.  
That's the Boundaryline promise.









# WHO WE ARE

---

We're a customer-focused team, dedicated to making it easy for anyone in New Zealand to get the fence they need. We listen to what you tell us and work with you to reach the best solution for your project.

Innovation has been at the heart of what we do at Boundaryline Fencing Systems since the company was founded in Invercargill, with a range of timber Post&Rail fencing many years ago. We quickly found there were people throughout the New Zealand construction industry that liked our way of doing things, so our range of fencing systems grew quickly

to meet the requirements of the market.

Today, with the widest range of fencing systems available on the New Zealand market and located in Auckland, Christchurch, and Invercargill – we have the products, service, and attitude to make fencing easy for you.



## PEOPLE FIRST

---

Boundaryline is a part of the communities we work in. People and relationships are paramount to our success.



## LOYALTY

---

Boundaryline is an established market leader in the fencing and gate industry, and recognises the driving forces that got us there. We are loyal to ourselves, our customers and our company.



## INNOVATION & CHANGE

---

As innovators, Boundaryline is always looking for ways to develop, improve and lead industry change while staying true to our values.



## FAIRNESS

---

Boundaryline stand by our work and exceptional service. Every deal must stand the test of time.

# AUCKLAND

## DISTRIBUTION & SHOWROOM

6 Harbour Ridge Drive, Wiri

 (09) 250 1144



# CHRISTCHURCH

## DISTRIBUTION & SHOWROOM

22 Islington Ave, Islington

 (03) 347 3191



# INVERCARGILL

## DISTRIBUTION & SHOWROOM

60 Bastian Street, Waikiwi

 (03) 211 5145



# CONTENTS

---

21	DURAPANEL™
29	ELITEWALL™
35	COLOURPANEL™
39	SMARTWALL <sup>NEW</sup>
43	COLOURSLAT™
46	GREEN SCREEN
49	SENTRYPANEL™
54	KIWI PANEL™
57	POST&RAIL
60	LIFESTYLE TIMBER GATES
62	TIMBER BOLLARDS
65	CUSTOM ENTRANCE GATES

## ICON KEY



### STOCK ITEM

This is a stocked product line and will normally be available for following day dispatch.



### CUSTOM ITEM

This is a non-stocked product item. Talk to us about lead time.



### CUSTOM COLOURS AVAILABLE

Alternative colour finishes are available for this product at an added cost, talk to us about the options.



### WARRANTY

Product is covered for warranty under the conditions of Boundaryline's warranty agreement, a copy of which is available on request.

**1.** © Copyright June 2017. All rights reserved. No part of this publication may be reproduced in any form without written permission of Terranota Ltd.

**2.** The purpose of this catalogue is to showcase the Boundaryline range of fencing and gate solutions available from Terranota Ltd. While Terranota Ltd has made every effort to portray accurate descriptions and information within this catalogue, Terranota Ltd cannot accept any responsibility for specifications or completed work based on information in this catalogue. In all construction projects, care must be taken to comply with all relevant statutory requirements and recommended codes of practice. The customer or user must establish the suitability of any product purchased for their own safe use.

**3.** Terranota Ltd reserves the right to update or change any specifications in this catalogue without prior notice. Products may be deleted, amended, substituted or changed at the sole discretion of Terranota Ltd.

**4.** Trademarks: Terranota, Boundaryline, DuraPanel, ColourPanel, SentryPanel, EliteWall, KiwiPanel, EuroMesh and KiwiLink are trademarks of Terranota Ltd, some of which are registered trademarks. Terranota Ltd will not hesitate to take legal action to protect the company's proprietary rights in this regard.

**5.** Any measurements shown are intended as a guide only. Please confirm any critical measurement with Terranota Ltd.



# GARDEN & BOUNDARY

---

When selecting a fence for your home and garden, consider the spaces that the fence will border, and define the correct balance between a solid fence for privacy versus a less constricting open-style.

The Boundaryline team are here to assist you in enhancing, protecting, and adding value to your important investment - the family home.









# POOLS

---

Selecting a fence to surround your pool that will provide you peace-of-mind while enhancing the poolside landscape is key. The Boundaryline team have the knowledge and experience to ensure you choose a great looking fence while meeting all your obligations under the Building code for pool safety.

Boundaryline's range of modular systems including DuraPanel, EliteWall, and SmartWall, can be combined to create your own unique oasis.









# LIFESTYLE

---

The freedom of open spaces, and the peacefulness of distance between neighbours is what endears the kiwi lifestyle block to many.

Boundaryline Post&Rail has been the first choice of fencing for lifestyle property owners and farmers for many years. We complete the range with the classic timber lifestyle gate range to create a grand entranceway to your property.









# COMMERCIAL & SECURITY

---

Choosing a better fence for your commercial property will increase the investment value and ensure sufficient intruder deterrence, while remaining inviting for clients and staff.

Boundaryline commercial and security fencing solutions combine strength with style, durability with low-maintenance, and provide long-term hassle-free property protection. Matching gates and automation solutions are a key component for commercial sites, and we can provide recommendation on site-specific requirements.







# MEDIUM-DENSITY HOUSING

---

Medium-density housing may require a compromise on land and exterior spaces, however that doesn't need to mean a compromise on quality of lifestyle. Well-designed fencing can significantly enhance outdoor living areas while providing privacy and maximizing the available footprint.

Boundaryline's range of modular fencing systems, combined with our team's experience providing solutions for medium-density projects, ensures we can provide you the best-suited solution for your project.









# EDUCATION

---

The Boundaryline range provides many fence and gate options to meet the demands of childcare, primary, and secondary school environments.

The Boundaryline team have extensive experience in supplying solutions for schools with completed projects throughout the country; from the far north to the deep south. We work closely with specifiers, project managers, and installation contractors to ensure each project is completed within the required time-frame and budget.





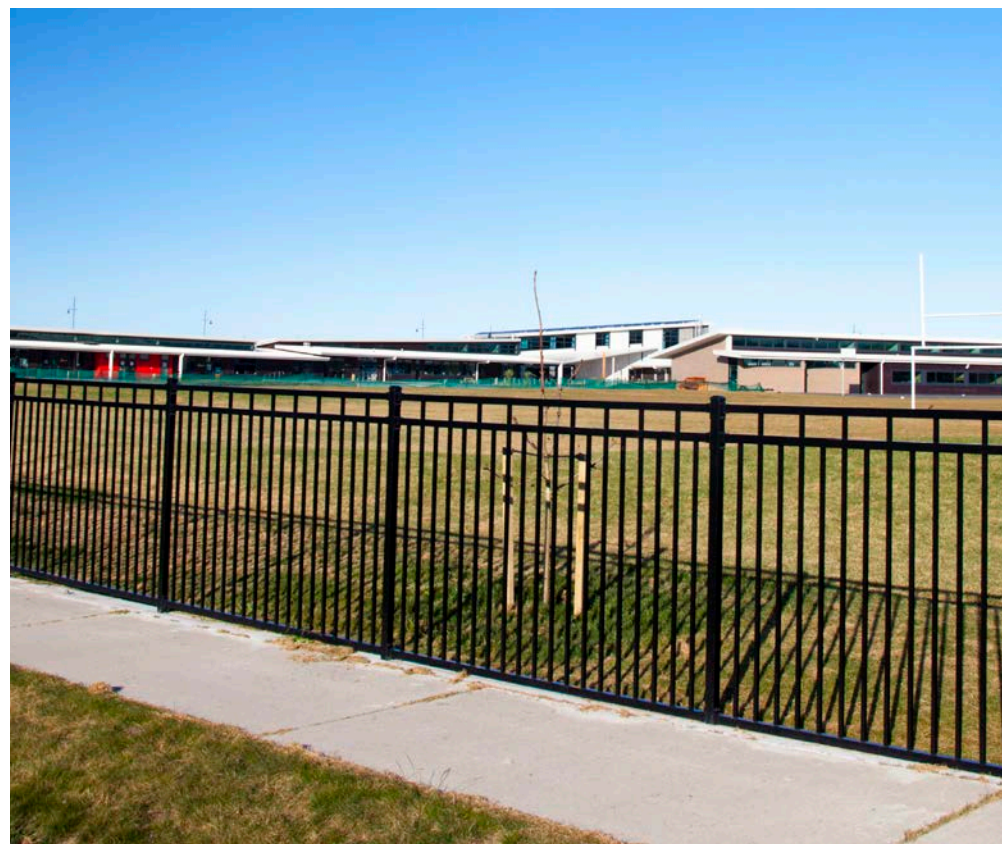



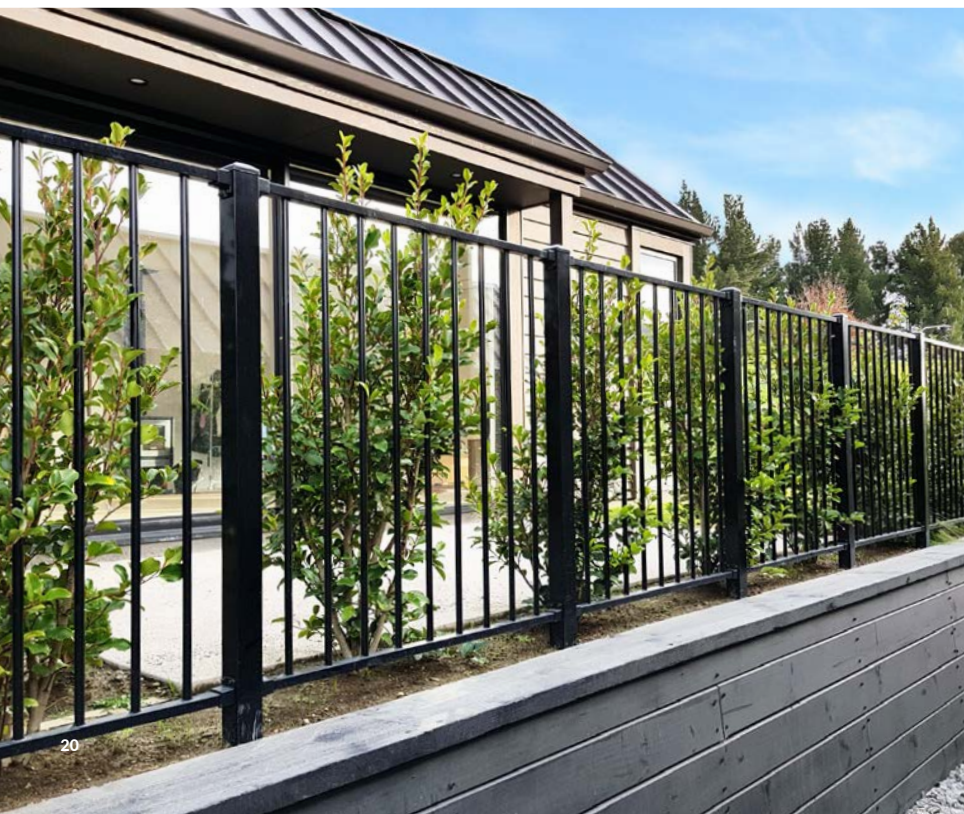



# DURAPANEL™

## SMART FENCING FOR HOMES, POOLS AND SCHOOLS

Boundaryline DuraPanel tubular metal fencing offers a wide range of options for pool fencing, landscape fencing, schools and childcare centres. With high-quality components and a sleek, cohesive design, DuraPanel complies with all New Zealand pool fencing regulations to keep children safe and to meet council requirements.

Our DuraPanel aluminium range is designed for increased strength and offers great-looking property enhancement and protection at a cost-effective price.

The DuraPanel range of custom-made fencing offers a wide variety of styles and colours to meet specific design requirements for any project.

All DuraPanel fencing is designed to be simple and quick to install, with modular components and welded panels.

Producer statements are available for pool fencing, balustrade, and retaining wall fencing compliance.

“

The fencing was the best we have seen. Very nice to use, brilliant finish and the boss is pleased. We're stoked and will always be recommending it to others.

Nelson swimming pool suppliers



# DURAPANEL™

## DESIGN OPTIONS



### DELTA

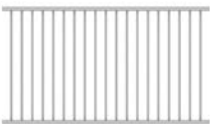

Panel height: 0.95 / 1.2m      Panel length: 2.250m  
Post size: 50x50mm      Vertical bars: 19x19mm  
Horizontal rails: 40x40mm  
*0.95m / 1.2m rakeable panel also available for sloping ground*



### VECTA



Panel height: 1.2 / 1.5m      Panel length: 2.250m  
Post size: 50x50mm      Vertical bars: 19x19mm  
Horizontal rails: 40x40mm  
*Reversible, can be installed with rods facing down*



### POLO



Panel height: 1.2 / 1.5 / 1.8m      Panel length: 2.250m  
Post size: 50x50 / 65x65mm      Vertical bars: 19x19mm  
Horizontal rails: 40x40mm



### AXIS



Panel height: 1.2m      Panel length: 2.250m  
Post size: 50x25mm      Vertical bars: 50x25mm  
Horizontal rails: 25x25mm



### TITAN



Panel height: 1.2m      Panel length: 2.330m  
Post size: 65x65mm      Vertical bars: 19x19mm  
Horizontal rails: 50x25mm  
*1.2m rakeable panel also available for sloping ground*

## WHAT'S GREAT ABOUT DURAPANEL™

### STRONG

40x40mm rails



\*Titan - 50x25mm

### 19x19mm SQUARE VERTICALS

For added strength and better appearance

### ALUMINIUM CONSTRUCTION

This fence won't rust

### POOL-SAFETY DESIGN

Keeps children safe and meets all regulations



### STURDY POSTS

50x50mm or 65x65mm  
with matching cap



### HIGH QUALITY

Powder-coated finish  
Standard in black

### QUICK AND SIMPLE INSTALLATION

Modular system with  
screw-on brackets





# DURAPANEL™ TITAN SAFETY FENCING

## FIXING SOLUTIONS

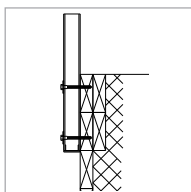

### **SIDE TO DOUBLE BOARD**

Side fixed to double board retaining wall

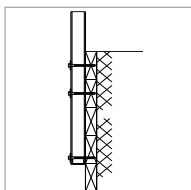

### **SIDE TO SINGLE BOARD**

Side fixed to single board retaining wall

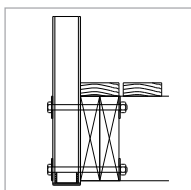

### **SIDE TO TIMBER DECK**

Side fixed to timber deck

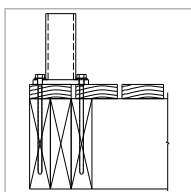

### **TOP TO TIMBER DECK**

Top Fixed to timber deck

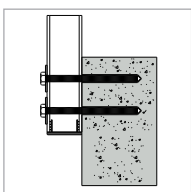

### **SIDE TO CONCRETE**

Side fixed to concrete



### **SAFETY FROM FALLING COMPLIANT**

DuraPanel™ Titan is a fencing system design-engineered to meet F4 Safety from Falling compliance when installed to manufactures specifications. It is NZ's first aluminium safety fence that can be installed at 2.4m centres and while meeting the NZBC F4 specification requirements.



### **RETAINING WALL, BALUSTRADE OR CYCLEWAY**

## WHAT'S GREAT ABOUT **TITAN** SAFETY FENCING

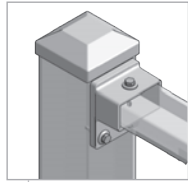

**ALUMINIUM BRACKET**  
Boundaryline DAB5025

**ALUMINIUM BRACKET  
FOR RAKING PANEL**  
Boundaryline DAR5025

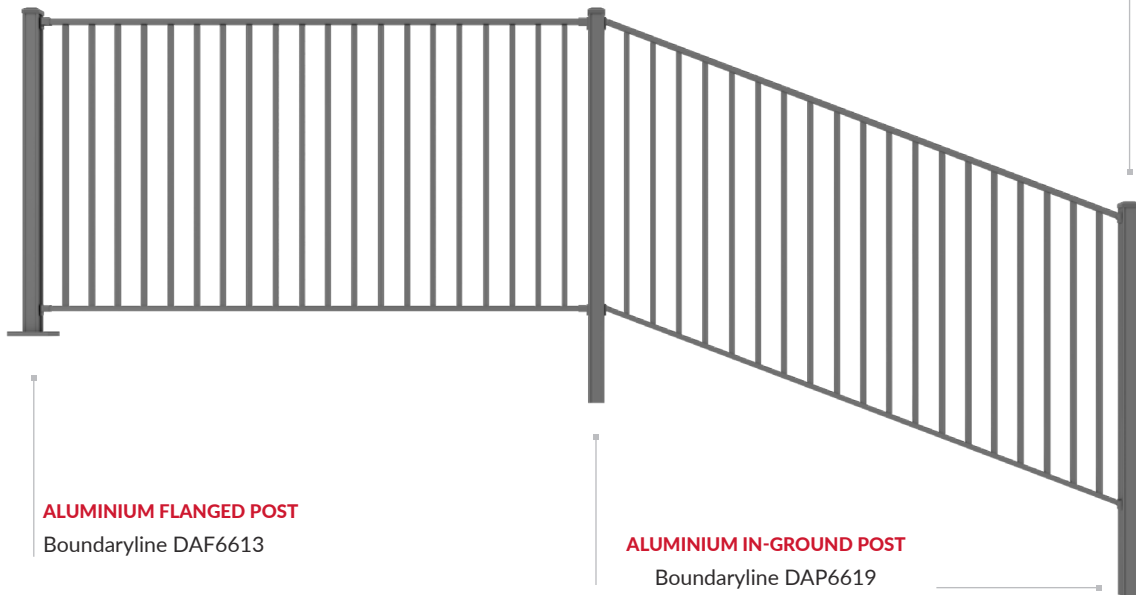
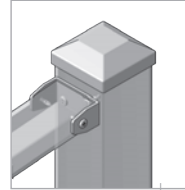

**RAKING PANEL:**  
Rakes to meet  
slopes of up to  
43°

**ALUMINIUM FLANGED POST**  
Boundaryline DAF6613

**ALUMINIUM IN-GROUND POST**  
Boundaryline DAP6619

### SPECIFICATIONS

Aluminium, powder-coated finish. NZBC F4 compliant at 2.4m post centre

**Panel height:**  
1200mm (approx 1250mm high when installed)

**Panel lengths:**  
2330mm

**Post Centre:**  
2400 TYP Post Centres with 65x65 Posts

Visit [boundaryline.co.nz/resources](https://boundaryline.co.nz/resources) to download Producer Statements, Technical Support & CAD drawing files.





DURAPANEL™  
GATES

DELTA

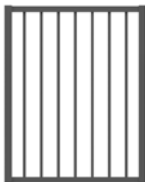

Height: 0.95 / 1.2m  
Length: 0.95m

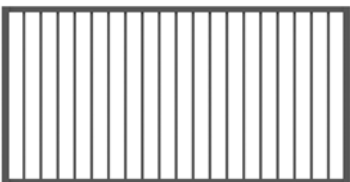

Height: 0.95 / 1.2m  
Length: 1000-2300mm

VECTA



Height: 1.2 / 1.5m  
Length: 0.95m

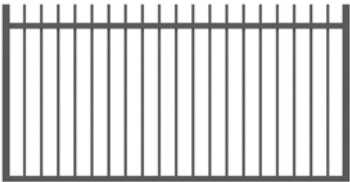

Height: 1.2 / 1.5m  
Length: 1000-2300mm

POLO



Height: 1.2 / 1.5 / 1.8m  
Length: 0.95m



Height: 1.2 / 1.5 / 1.8m  
Length: 1000-2300mm

AXIS

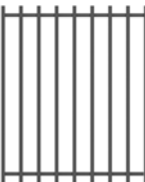

Height: 1.2m  
Length: 0.95m



Height: 1.2m  
Length: 1000-2300mm









ELITEWALL™

NEW ZEALAND'S  
PREMIUM  
PANEL FENCE

The EliteWall system is the preferred choice for property owners who require a cost-effective, solid panel fence that provides style, function and privacy.

EliteWall is New Zealand's most advanced line of modular panel fencing. Made with lightweight components, yet structurally strong and simple to install.

Superior acoustic performance makes EliteWall a popular option for rest homes and motels, or any property beside a busy road.

EliteWall is the ideal alternative to concrete or block walls at a fraction of the cost, and is suitable for fencing in earthquake zones.

A complete range of infill options gives you the flexibility to choose any combination of panels between the posts: solid panels, pool fencing panels, or aluminum slats. The many different design possibilities are extensive.

“

I am very pleased with the look and the feel the new fencing is starting to create already. Thank you for all your efforts.

Facility manager, rebuild project,  
Christchurch



# ELITEWALL™

## DESIGN OPTIONS



### CLASSIC WALL

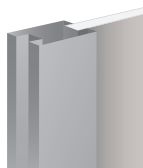

Wall height: 0.9m – 2.1m  
Panel thickness: 50mm  
Posts: 180x120mm  
Post centres: 2.530m / 2.830m / 3.130m



### SIGNATURE WALL

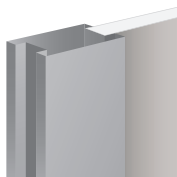

Wall height: 0.9m – 3.0m  
Panel thickness: 70mm  
Posts: 280x140mm  
Post centres: 2.630m / 2.930m / 3.230m

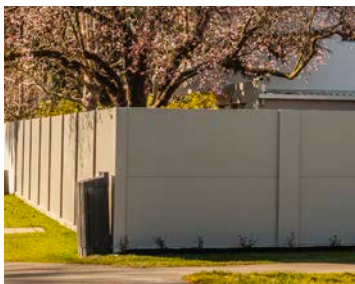

### ESTATE WALL

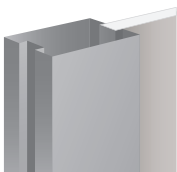

Wall height: 0.9m – 3.0m  
Panel thickness: 70mm  
Posts: 320x210mm  
Post centres: 2.670m / 2.970m / 3.270m

## WHAT'S GREAT ABOUT ELITEWALL™



### SUPERIOR ACOUSTIC PROPERTIES

Blocks up to 28 decibels of noise, great for properties beside a busy road

### NO MASONRY TO CRACK

Allows for ground movement  
Works well in an earthquake zone

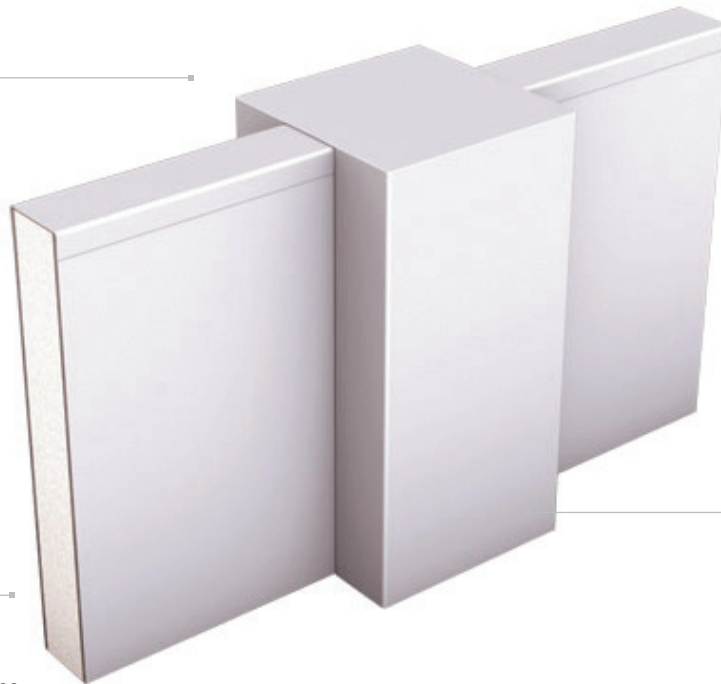

### COST-EFFECTIVE PRIVACY

Solid fencing at a much lower cost than concrete

### QUICK AND SIMPLE INSTALLATION

All modular components and minimal site disturbance

### PAINTED TO MATCH YOUR PROPERTY

Easy to texture-coat and paint





# ELITEWALL™

## FINISHING OPTIONS

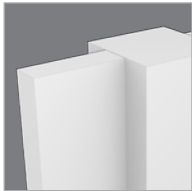

### CONTEMPORARY

Contemporary panel caps and post caps



### SUBURBAN

Traditional panel caps and contemporary post caps

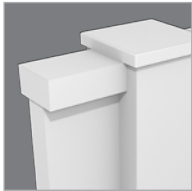

### TRADITIONAL

Traditional panel caps and traditional post caps



### NEGATIVE DETAIL JOINT

Enhance the look by utilising the panel joint with horizontal detail



### CLOSED PANEL JOINT

For a refined joint detail



### ALUMINIUM SLATS

Aluminium slats provide an open-feel while maintaining a level of privacy for the property owner. Aluminium slats are supplied in a powder-coated finish and can be colour-matched to any standard New Zealand roof or window colour.



### LOUVRES

Aluminium louvre in-fills provide privacy and security with an upmarket offer a contrasting design aesthetic. Aluminium louvres are supplied with a powder-coated finish and can be colour-matched to any standard New Zealand roof or window colour.



### DURAPANEL™ INFILL

EliteWall columns are available in a range of sizes and heights and can be supplied with a spray-texture finish or painted in colour of your choice for quick and easy installation. See DuraPanel on page 21.



### GREEN SCREEN INFILL

Greenscreen infill option provides a unique mesh design element to encourage the growth of climbers and plants. When combined with EliteWall it offers the softness of nature as well as the promise of privacy.



### LETTERBOXES

EliteWall letterbox is available as stand-alone letterbox columns or built into an EliteWall post or panel. A range of styles and finishes are available including front and rear-opening options.







# COLOURPANEL™

## SETTING THE STANDARD IN RESIDENTIAL FENCING

For great-looking, low-maintenance privacy fencing, Boundaryline ColourPanel sets the standard throughout New Zealand. No more twisted or rotten timber fences!

ColourPanel is truly a same-both-sides fence, which makes it ideal for residential properties because both neighbours get the 'good' side of the fence.

ColourPanel is made from pre-finished steel, as commonly used for roofing, and is durable and stable. It

will not warp and twist like a timber fence, even when a dark colour is used in any climate.

Installation is very quick and simple with modular, colour-matched components. Even DIY customers are impressed with how easy it is to get the job done!

All ColourPanel needs to maintain the same look as the day it was installed is an occasional wash-down. No painting, no staining, no problems!

“

I'm definitely impressed with it, especially the strength of it... it looks really good.

Fencing contractor,  
Marlborough



# COLOURPANEL™

## DESIGN OPTIONS



### CLASSIC

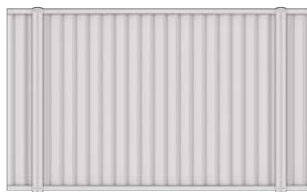

**Fence height:** 1.2m / 1.5m / 1.8m (in stock)  
0.9m / 2.4m (available to order)  
2.1m in stock in Black, Thunder, Slate Grey

**Panel profile:** Reflect panel

**Post centres:** 2.380m



### SLAT-TOP



**Fence height:** 1.5m / 1.8m / 2.1m (in stock)  
Available in Black, Thunder, Slate Grey  
1.2m / 2.4m (available to order)

**Panel profile:** Reflect panel with 300mm slat panel

**Post centres:** 2.380m

*More colours available to order*

## WHAT'S GREAT ABOUT COLOURPANEL™

### ULTRA-LOW MAINTENANCE

The fence that never  
needs painting or staining

### SAME-BOTH-SIDES

Both neighbours see the  
'good side' of the fence

### PRE-FINISHED COMPONENTS

All parts are colour-matched

### LONG-TERM DURABILITY

4-step anti-corrosion process

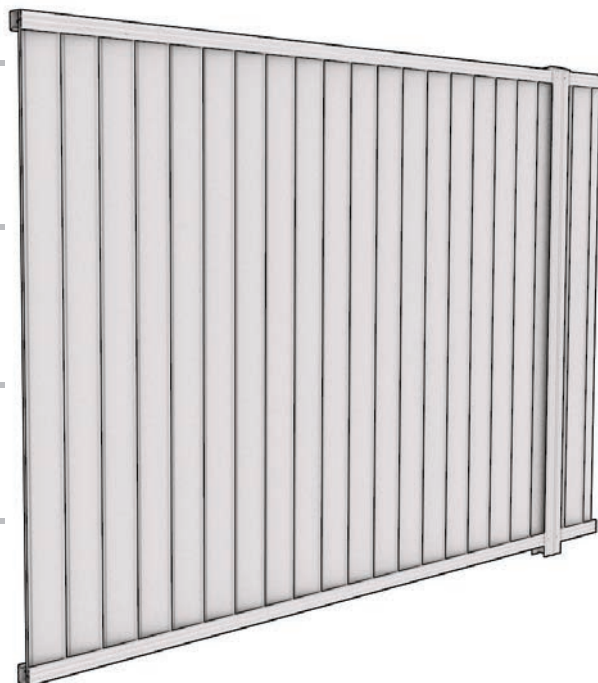

### QUICK AND SIMPLE INSTALLATION

Cost-effective  
modular system



### COMPLETE PRIVACY

No gaps in the panels

### NO TWISTING, NO WARPING

ColourPanel will  
always look new

## COLOUR SELECTION



Black

Thunder

Slate Grey

Shingle

Mountain Blue

Rivergum

Merino

Frost

More custom colours available to order

Colours are shown as accurately as printing allows







# SMARTWALL

BLENDING  
SEAMLESSLY  
WITH NATURAL  
SURROUNDINGS

Create beautiful natural boundaries to compliment your new landscape with Boundaryline's SMART alternative for timber fencing.

SmartWall features steel posts and rails with CLT laminated palings to prevent twisting and warping over time, ensuring you have a premium looking boundary solution for years to come.

With its cross-laminated timber palings and same look both sides, SmartWall creates a tidy, elegant

finish with ultimate stability for every project.

The superior acoustic performance of SmartWall makes it the ideal choice for residential and commercial projects including childcare centres and rest-homes where noise-minimisation is a requirement.

The modular construction makes SmartWall one of the easiest and fastest fences to install, saving you time and money.

“

I'm definitely supplying it... It is a cost effective product with a great look, and is also very durable which suits our intense climate.

Fencing contractor,  
Central Otago



# SMARTWALL

## DESIGN OPTIONS



### VERTICAL



- Fence height: 1.8m
- Paling profile: CLT laminated palings
- Post centres: 2.250m



### HORIZONTAL



- Fence height: 1.2m / 1.5m / 1.8m
- Paling profile: CLT laminated palings
- Post centres: 1.830m

## MORE ABOUT CLT LAMINATED PALINGS

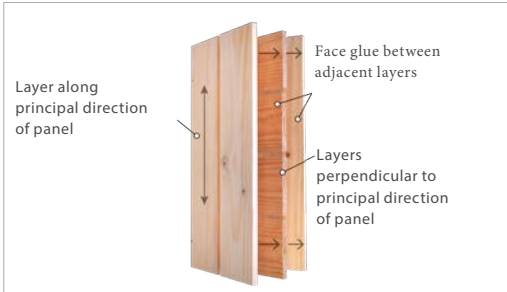

CLT laminated palings by Laminata are a cross-laminated timber plank developed using high-performance European glue lamination technology.

The gluing of three layers of timber with the middle layer at right angles to the outer layers provides maximum stability and strength.

MiniCLT planks are treated using the environmentally preferable MicroPro timber treatment which is GreenGuard certified for play areas used by children of all ages.

# WHAT'S GREAT ABOUT SMARTWALL

## SAME-BOTH-SIDES

Both neighbours see the 'good side' of the fence

## ULTIMATE STABILITY RADIATA PINE

CLT laminated palings for ultimate stability



## SUPERIOR ACOUSTIC PROPERTIES

Ideal for reduction of noise beside busy roads, and child-care centres.

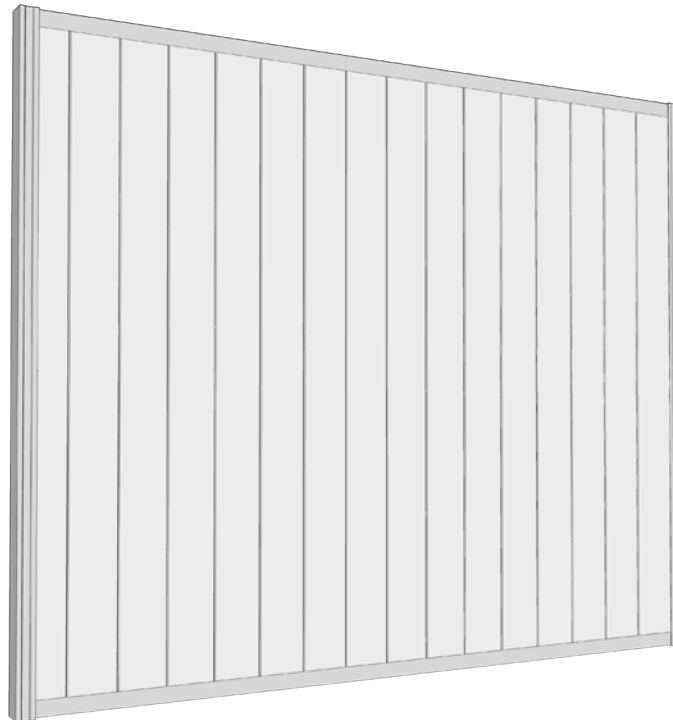

## QUICK AND SIMPLE INSTALLATION

Modular system for quick install

## COMPLETE PRIVACY

CLT laminated palings are tongue & groove profile to prevent any gaps



## STRUCTURAL INTEGRITY

Pre-finished steel post & rails to prevent twisting and warping over time

## COLOUR SELECTION for Posts & Rails



Black

Thunder

Slate Grey

## DESIGN OPTIONS



SmartWall Horizontal  
1830mm Post Centre



SmartWall Vertical  
2250mm Post Centre

Custom colours available for Posts & Rails

Colours are shown as accurately as printing allows









COLOURSLAT™

SMART,  
INTEGRATED  
PRIVACY  
SCREENING

Boundaryline ColourSlat is the ideal choice for screening outdoor living areas and courtyards, as it allows natural light penetration while providing privacy.

For best appearance and long-term durability, choose the standard steel ColourSlat. This is a complete system using pre-finished steel components and will not fade, warp, or twist.

If you are looking for an alternative to an all-steel fence, ColourSlat with timber panels will meet your requirements. The timber slat infill panels are manufactured from high-grade radiata pine and can be stained to the colour of your choice.

ColourSlat is designed to seamlessly integrate with ColourPanel fencing, or it can be installed as a stand-alone fencing system.

“

We were looking for an attractive, low-maintenance slat fence to surround a new outdoor patio area and ColourSlat has met the need perfectly. We are very pleased.

**Commercial building owner, Invercargill**



# COLOURSLAT™

## DESIGN OPTIONS



### STEEL

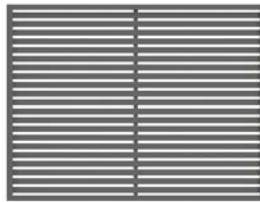

**Fence height:** 1.2 / 1.5 / 1.8m

**Slat size:** 55x7.5mm

**Slat spacing:** 15mm / 25mm

**Post centres:** 1.23m / 2.38m



### SIGNATURE TIMBER

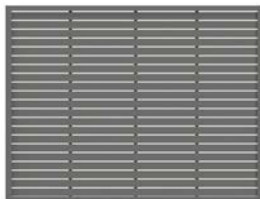

**Fence height:** 1.2 / 1.5 / 1.8m

**Slat size:** 70x12mm

**Slat spacing:** 11mm

**Post centres:** 2.38m

**Timber infill:** Radiata pine H3

## MORE THAN JUST A FENCE



ColourSlat Fencing is a great option for privacy screens around decks, patios, wheelie bins and any areas that you want privacy without a block out fence.

ColourSlat fencing can be integrated with ColourPanel and SmartWall.

## WHAT'S GREAT ABOUT COLOURSLAT™

### IDEAL FOR SCREENING

Provides privacy without being closed in

### PRE-FINISHED COMPONENTS

All parts are colour-matched

### LONG-TERM DURABILITY



### QUICK AND SIMPLE INSTALLATION

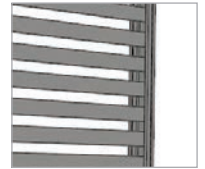

### MODULAR COMPONENTS

Can be integrated with ColourPanel

## COLOUR SELECTION



Slate Grey

Black

Thunder

More custom colours available to order

Colours are shown as accurately as printing allows







# GREEN SCREEN

GREEN FENCING  
MADE EASY

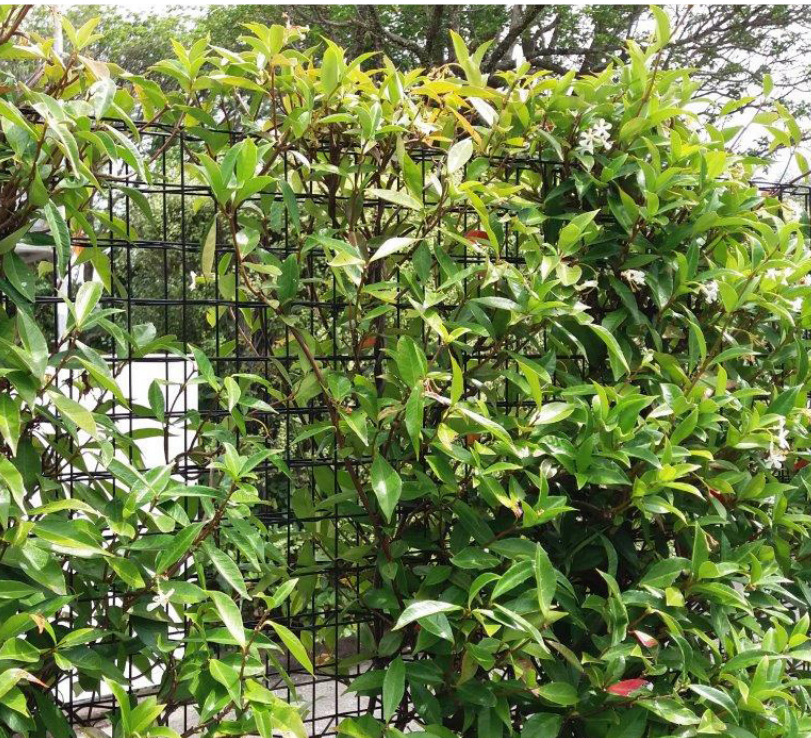

Introducing a unique mesh fence panel designed to support climbers and plants. Green Screen provides an initial security and barrier as a modular fence system, while the unique integrated mesh design encourages growth of climbers and provides maximum support for the most delicate plants.

Over time the fence will form a dense and uniform green wall that blends in with nature and enhances the landscape. Green Screen is a practical and great-looking landscape feature for any property.

Green Screen is a component based system and easy to install between the standard slim-line posts, or any column design of your choice.

## WHAT'S GREAT ABOUT GREEN SCREEN

### EXCELLENT VERSATILITY

The modular panel can be used as a standard fence line, or mounted between columns of your choice

### SPECIFICATIONS

Panel height: 1220mm

Panel length: 2233mm

Panel thickness: 50mm

Aperture: 50x50mm

Finish: Powder-coated

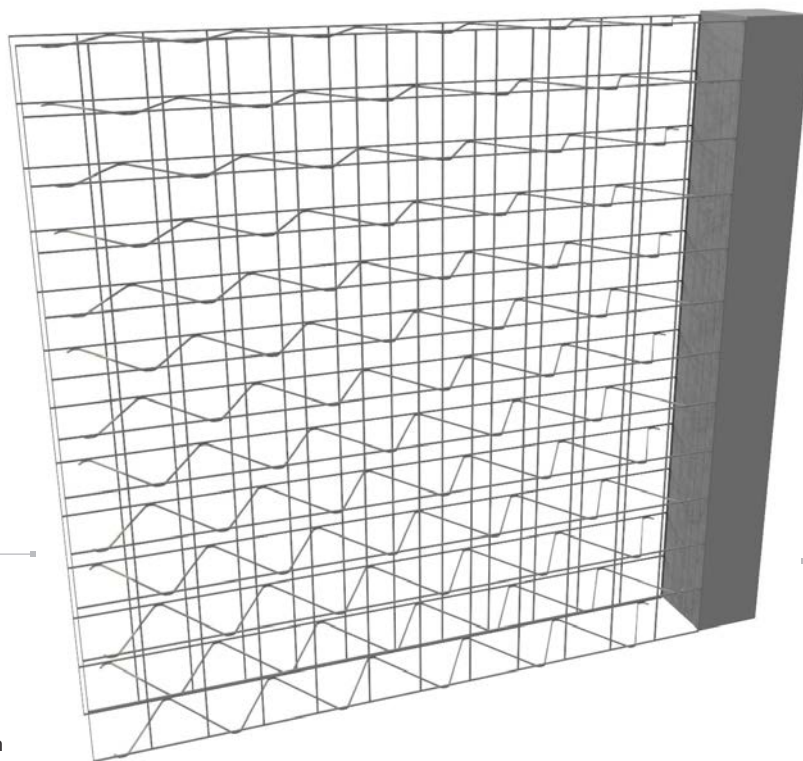

### QUICK AND SIMPLE INSTALLATION

Easy clip installation

### HIGH QUALITY

Powder-coated finish  
Standard in black

### SUPERIOR CORROSION PROTECTION

Galvanised steel and  
powder-coated finish  
for long-lasting good  
looks and safety









# SENTRY**PANEL™**

## THE GREAT- LOOKING HIGH- SECURITY FENCE

Boundaryline SentryPanel is designed to provide superior protection of your investment and look great at the same time.

The spear-top option has sharply spiked bars to deter intruders and rod-top provides the same security without looking too unfriendly. Both styles have a long anti-climb gap making it a virtually unscalable barrier.

SentryPanel is constructed from heavy-wall aluminium componentry, welded for strength, and powder-coated for long-term durability. The modular design and comparatively light panel weight makes installation quick and easy.

SentryPanel is a smart, cost-effective security fencing solution for all types of commercial property.

“

We use the SentryPanel security fencing system and now call it our number one go-to product. It is strong, reliable, easy to work with and install economically.

Fencing retailer, Tauranga



# SENTRY **PANEL**™

DESIGN OPTIONS

## SPEAR-TOP

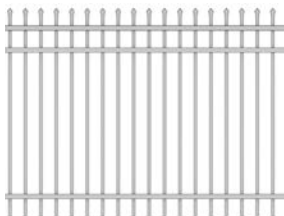

Panel height: 1.8m / 2.1m  
Panel length: 2.250m  
Horizontal rails: 40x40mm  
Vertical bars: 25x25mm  
Post size: 65x65mm  
Picket spacing: 110mm

## ROD-TOP

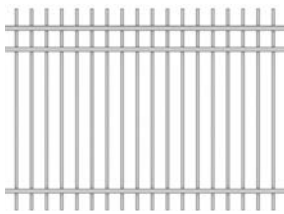

Panel height: 1.8m  
Panel length: 2.250m  
Horizontal rails: 40x40mm  
Vertical bars: 25x25mm  
Post size: 65x65mm  
Picket spacing: 110mm

## FLAT-TOP

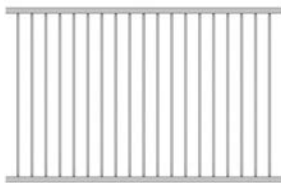

Panel height: 1.5m / 1.8m  
Panel length: 2.250m  
Horizontal rails: 40x40mm  
Vertical bars: 25x25mm  
Post size: 65x65mm  
Picket spacing: 95mm

## SCHOOL PANEL

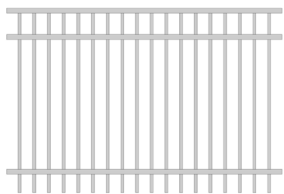

Panel height: 1.5m / 1.8m  
Panel length: 2.250m  
Horizontal rails: 40x40mm  
Vertical bars: 25x25mm  
Post size: 65x65mm  
Picket spacing: 95mm

## WHAT'S GREAT ABOUT SENTRY**PANEL™**

### **SPIKED-TOP**

Ideal when extra security is needed

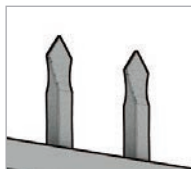

### **HARD TO CLIMB**

Long anti-climb gaps between rails

### **25X25MM VERTICAL BARS**

Strong vertical bars can't be easily bent

### **STRONG 40X40MM RAILS**

Includes double top rails for extra strength and better appearance

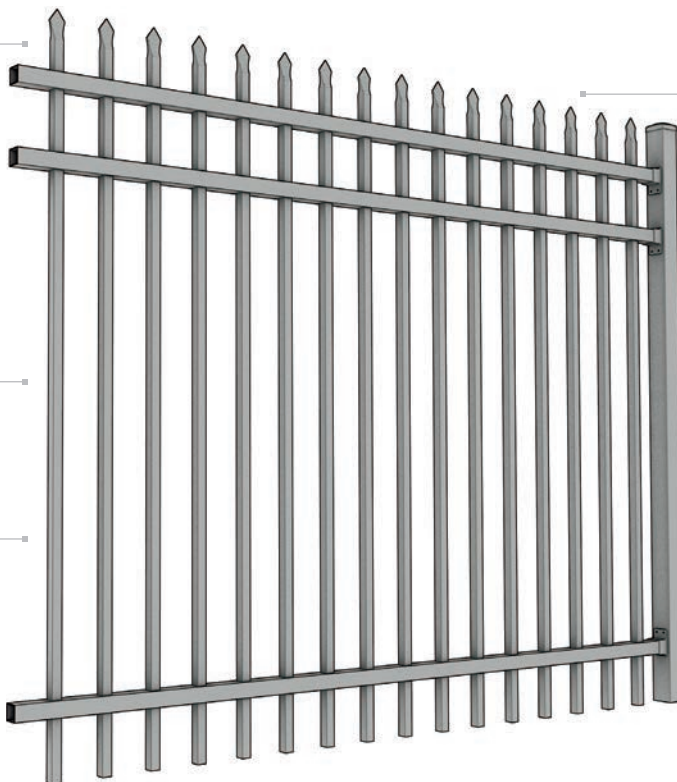

### **STURDY ALUMINIUM POSTS**

65x65mm with matching cap

### **QUICK AND SIMPLE INSTALLATION**

Modular system with screw-on brackets

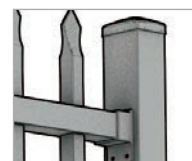

### **SUPERIOR CORROSION RESISTANCE**

Aluminium construction and powder-coated finish – this fence won't rust







# SENTRY**PANEL**<sup>TM</sup> GATES

## RELIABLE INDUSTRIAL SECURITY GATES

---

Many commercial and industrial properties require a high level of security to limit unauthorised access.

Boundaryline works with construction companies, property owners, and designers all over New Zealand to deliver reliable security gates solutions for all kinds of applications.

SentryPanel gates are manufactured using standard in-stock componentry to achieve a quick and cost-effective solution that will perform to perfection for the long-term.



## SECURITY GATE SOLUTIONS



### SWINGING GATES

Swinging gates are the most cost-effective option when there is enough opening space, or when the entranceway is not level. They can be automated if required, but are usually used when the gates are not opened frequently.



### TRACKED SLIDING GATES

Where traffic is relatively light, but a sliding gate is required, a tracked gate provides a cost-effective solution. The ground-track is very low profile and this type can be used with or without an automated opener.



### CANTILEVER SLIDING GATES

Boundaryline has had extensive experience in designing and building cantilevered sliding gates. With no ground-track required, a cantilevered gate is ideal for industrial situations that have heavy traffic or where the entranceway is not level.

## OPTIONS



### GATE AUTOMATION

Automated drivers available for swinging or sliding gates



### ACCESS CONTROL

A range of access control systems are available to suit every application

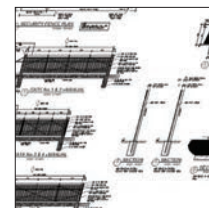

### CUSTOM DESIGNS

We can supply custom-made gates to meet your design requirements





**KIWIPANEL™**

**FOLDED-TOP  
SECURITY FENCING**



KiwiPanel is the ideal fencing system for cost-effective security in places such as pools, schools, and commercial properties. Manufactured to standard designs and specifications, these panels have superior anti-climb properties with a long anti-scale gap between the top and bottom horizontal wires.

Hot-dip galvanised for longevity, KiwiPanel is available in a standard galvanised finish or can be powder-coated to the colour of your choice.

## WHAT'S GREAT ABOUT KIWI**PANEL™**

### **STRONG & DURABLE COMPONENTS**

Made from tough welded steel wire, hot-dip galvanised to beat rust

### **LONG ANTI-CLIMB GAP**

For pool fencing and school boundary fences

### **SPECIFICATIONS:**

Panel height: 1.25m / 1.300m  
1.500m / 1.600m  
1.800m / 2.100m

Panel length: 2.400m

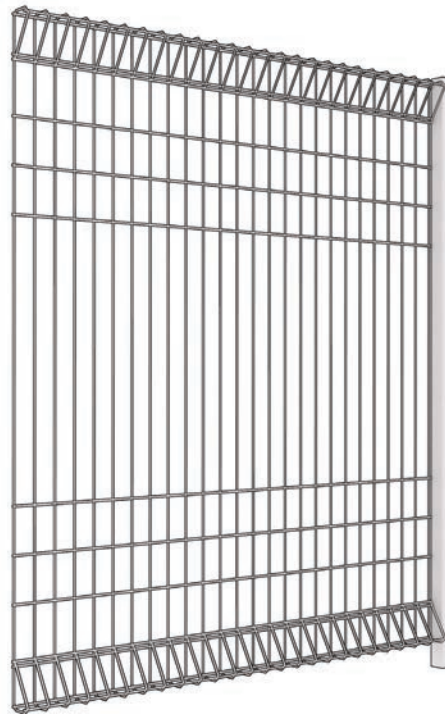

### **FOLDED TOP AND BOTTOM**

Folded profile makes this a strong, rigid design

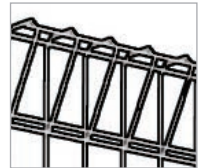

### **QUICK AND SIMPLE INSTALLATION**

Easy clip installation







# POST&RAIL

## THE VERSATILE FENCE

From lifestyle blocks to large farms, entranceways to subdivision projects, Boundaryline Post&Rail is used all over New Zealand and in all kinds of ways.

Property owners find Post&Rail to be a cost-effective and easy way to make a massive difference to the appearance of their property.

The unique Boundaryline straight-through mortise means that the rails interlock in the post without the use of any hardware. This makes a strong

fence that is simple to install, even on sloping ground and with curved lines. We use specially selected premium-grade timber to ensure our Post&Rail looks great for years to come.

With a wide range of options and the ability to supply custom-made systems, we can put together a Post&Rail solution exactly to your requirements and to enhance your landscape.

“

We are delighted with our Boundaryline fence. It was a joy to build and we continue to enjoy its good looks. Its contour and length certainly enhances our property.

Retired farmer - Hawarden,  
Canterbury



# POST&RAIL

DESIGN OPTIONS

## 2-RAIL

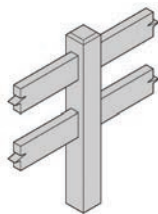

	CLASSIC 112	SIGNATURE 115	SIGNATURE 200
Post size:	125x125mm	150x150mm	200x200mm
Height out of ground:	0.95m - 1.05m	0.95 - 1.05m	0.95 - 1.05m
Rail length:	2.1m or 2.4m	2.1m or 2.4m	2.1m or 2.4m

## 3-RAIL

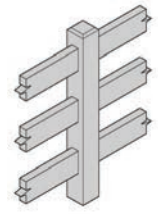

	CLASSIC 112	SIGNATURE 115	SIGNATURE 200
Post size:	125x125mm	150x150mm	200x200mm
Height out of ground:	1.1m - 1.2m	1.1m - 1.2m	1.1m - 1.2m
Rail length:	2.1m or 2.4m	2.1m or 2.4m	2.1m or 2.4m

## CUSTOM SOLUTIONS



Talk to us about custom-designed Post&Rail fencing systems.

Whether it's oversized posts and rails, custom-shaped post tops, or a combination of great ideas, we can make your design a reality.

## WHAT'S GREAT ABOUT POST&RAIL

### SELECTED PREMIUM GRADE TIMBER

Superior landscaping timber. Selected to avoid twisting and splitting

### BEVELLED RAILS

To match the post-tops

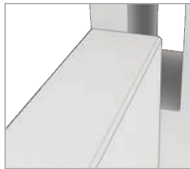

### PINE AND MACROCARPA

Treated pine for guaranteed durability or chemical-free, naturally durable macrocarpa

### FINISH

Rough sawn finish for a natural look

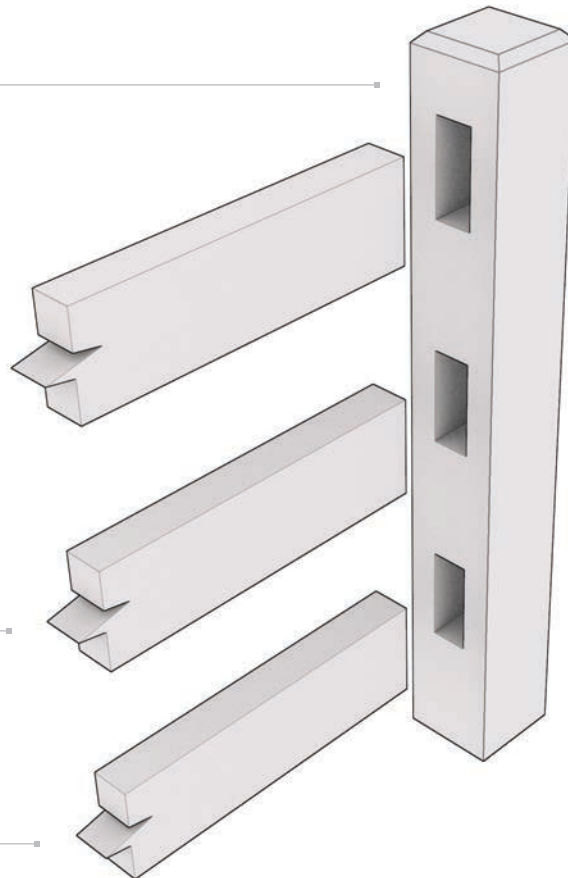

### CHAMFERED POST-TOPS

For a neat and tidy look

### STRAIGHT-THROUGH MORTISE

Strong and durable, easy to install, and no bulky brackets



### QUICK AND SIMPLE TO INSTALL

With the straight-through mortise, just set up the posts and slide in the rails







## LIFESTYLE **TIMBER GATES**

NOT YOUR AVERAGE  
FARM GATE

Boundaryline classic timber gates stand out from the crowd. Made in a traditional style to match our Post&Rail fencing, these are not your average farm gates.

With a focus on manufacturing quality, the classic timber gates have thicker rails for added strength, dressed timber for a sleek finish, and supplied with black powdercoated hardware and hinges to complete the look.

WHAT'S GREAT ABOUT **LIFESTYLE TIMBER GATES****DRESSED TIMBER**

For a refined appearance

**BOLTED CONSTRUCTION**

All joints are fixed with black bolts for strength

**HEAVIER RAILS**

For more strength

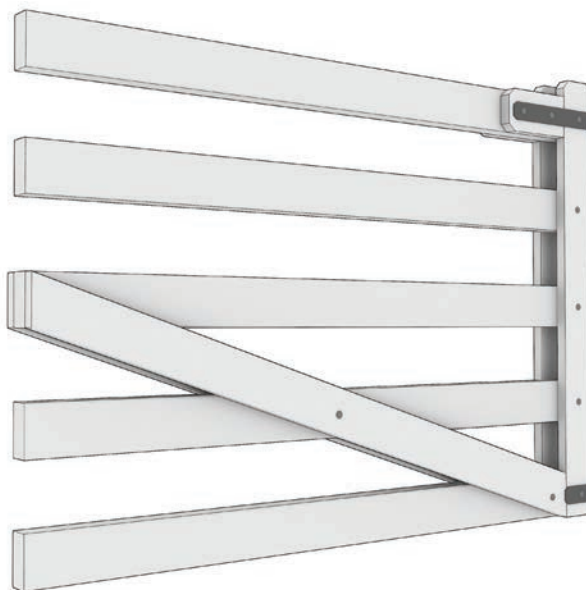
**WRAP-AROUND STRAP HINGES**

For strength and durability

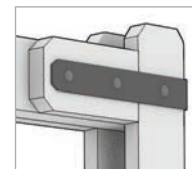
**BLACK HARDWARE AND LATCHES**

For a premium look

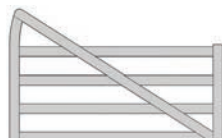
**SHEFFIELD****Height:** 0.9 / 1.0 / 1.2m**Length:** 1.0 / 1.8 / 2.1 / 2.4 / 2.7 / 3.0m or custom length - made to order**Rail size:** 90x32mm**Timber:** Treated pine or macrocarpa**MAYFIELD****Height:** 0.9/1.0/1.2m**Length:** 1.0 / 1.8 / 2.1 / 2.4 / 2.7 / 3.0m or custom length - made to order**Rail size:** 90x32mm**Timber:** Treated pine or macrocarpa**OAKFIELD****Height:** 0.9 / 1.0m**Length:** 1.0 / 1.8 / 2.1 / 2.4 / 2.7 / 3.0m or custom length - made to order**Rail size:** 90x32mm**Timber:** Treated pine or macrocarpa





## TIMBER BOLLARDS

FOR WHERE  
VEHICLES CAN'T GO  
BUT PEDESTRIANS CAN



Boundaryline bollards are the ideal cost-effective way to block vehicle access to parks, reserves and walkways, while allowing easy entry for pedestrians and cyclists.

Boundaryline bollards are made to our standard designs or to your own specification.

We use only premium landscape grade timbers: radiata pine and macrocarpa, or if required, a selection of sustainable hardwoods.

We manufacture custom-designed bollards including metalwork features and signage if required. Speak to us to make your ideas become reality.

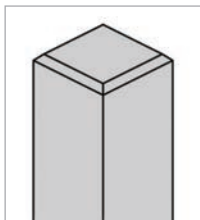
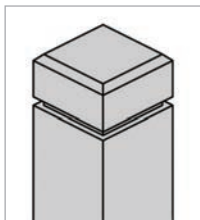
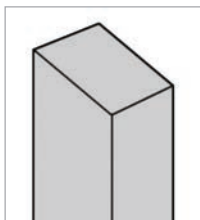
TIMBER **BOLLARD** SOLUTIONS**SQUARE BOLLARDS****SQUARE TOP****SQUARE TOP  
WITH COLLAR****ANGLE TOP**

**Post size:** 125x125 / 150x150 / 200x200mm

**Length:** 0.9 / 1.2 / 1.5 / 1.8m

**Timber:** Treated radiata pine or macrocarpa

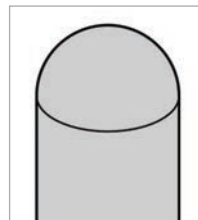
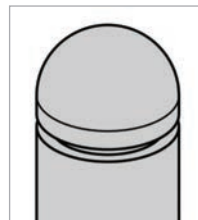
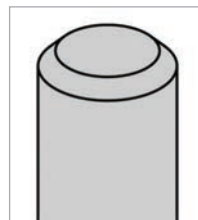
**ROUND BOLLARDS****DOME TOP****DOME TOP  
WITH COLLAR****CHAMFERED  
TOP**

**Post size:** 150mm / 200mm diameter

**Length:** 0.9 / 1.2 / 1.5 / 1.8m

**Timber:** Treated radiata pine







# CUSTOM ENTRANCE GATES

ENHANCE AND  
SECURE YOUR  
PROPERTY

Gates and entranceways are an important component of landscape design and are essential to secure and enhance your property.

The Boundaryline custom gates range is manufactured by our sister company Heritage Gates who for over 20 years has been a trusted manufacturer of custom fence and gate solutions.

Heritage Gates started out manufacturing wooden gates, but have perfected the art of replicating traditional timber styles in aluminium to achieve the same appearance with long-term durability and low-maintenance.

“

I love the fence and gates! The team were great to deal with and the result is impressive.

Christchurch lifestyle  
block owner

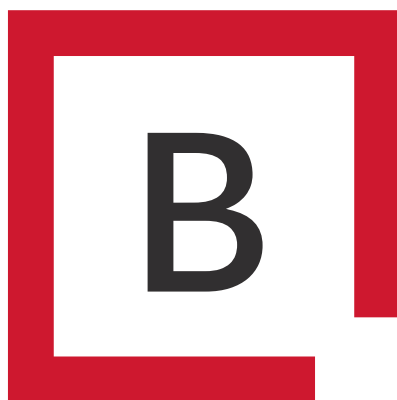

0800 003 006 / [boundaryline.co.nz](http://boundaryline.co.nz)